



LPG  
GROUP



Our Nozzles are installed in lot of gas stations around the world.

They are handled thousands of times every single day, held, used, dropped by distraction and constantly in contact with aggressive substances and used even in extreme climatic situations.

That's why we designed and realized the HQ range.

HQ: Italian high quality which guarantees you the maximum efficiency and resistance.



LPG 800 Series

HQ

The nozzles providing LPG are an Italian product with an excellent quality. The full range is the result of 30 years of strong background. They are produced totally in Italy in LPG Industrial plant with high quality raw materials and it's produced in order obtain the best efficiency.

**Type of coupling:** ITALIAN DISH

**Hooking on car taken over:** 3 RADIAL HAMMERS with increased hooking area on car taken over in more safe way.

**Release system:**

**UNHOOKING SYSTEM** it allows disconnect the nozzle from the taken over with a simply movement of a finger.

**Materials:** aluminium, brass, NBR and nylon. They ensure a high resistance keeping a value for money.

**Available colours:**

black, blue, red, yellow, green.

**Sleeve:** available for nation of use.

**Maintenance:** Easy and programmable. It can be carried out by one of your operators and it will maintain your nozzle perfectly efficient and safe.

**Release of LPG :** extremely low during disconnection.

**Optional:** lever for housing in nozzle boot of the NBL Series.

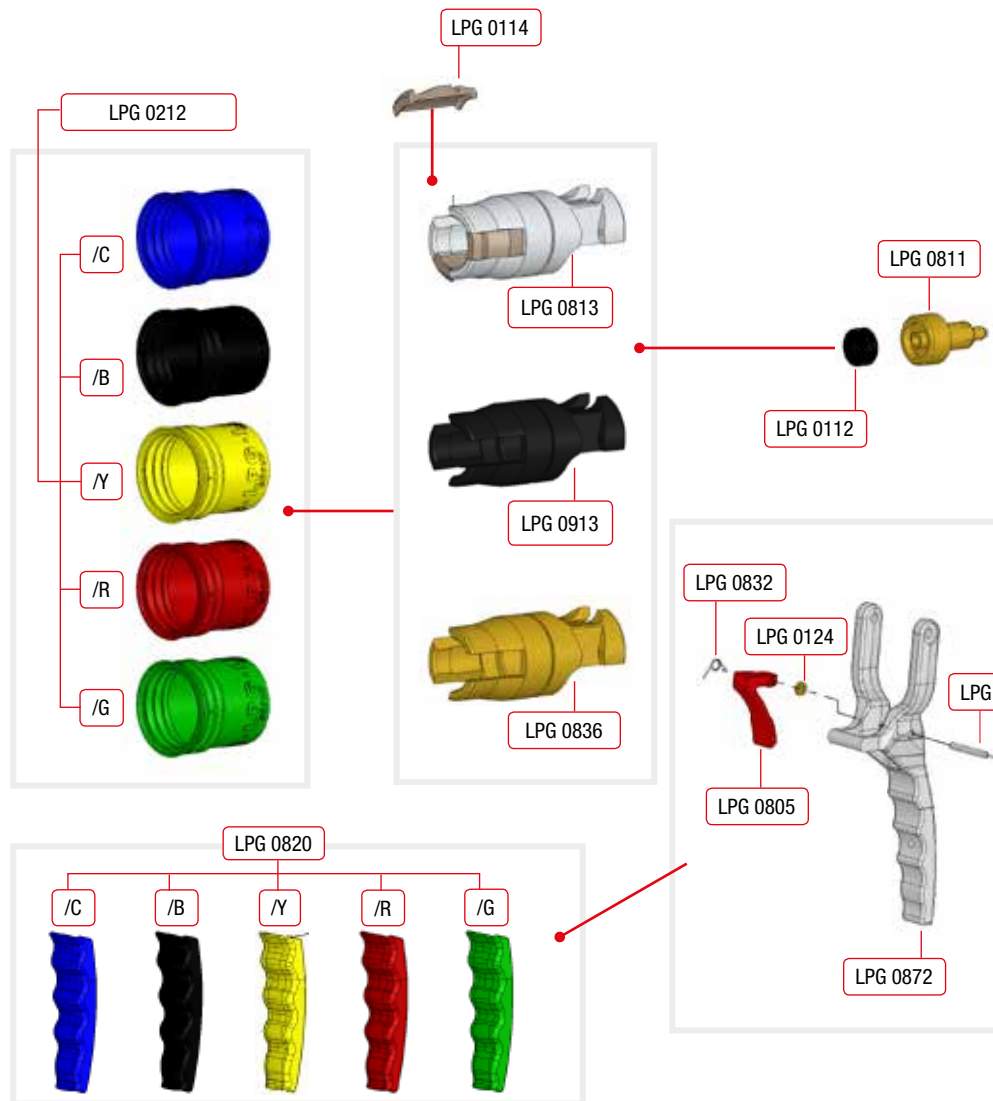

Code	Q.ty	Article	Material
LPG 0102	1	Bushing	Brass
LPG 0103	1	Plus Bush	Steel-Abs
LPG 0104	1	Swivel 1" Gas	Steel
LPG 0106	1	Standard Lever	Aluminium
LPG 0112	1	Piston Gasket	Nbr
LPG 0114	3	Standard Hammer	Brass
LPG 0115	2	Roll	Abs
LPG 0116	1	Spring Sleeve	Steel
LPG 0117	1	Spring Head	Steel
LPG 0119	1	Valve Gasket	Sealthane
LPG 0123	1	Trigger Spacer	Steel
LPG 0124	1	Trigger Spacer	Steel
LPG 0201	6	Ball	Steel
LPG 0202	1	Flexible Ring	Steel
LPG 0203	2	O-Ring Corpo	Nbr

Code	Q.ty	Article	Material
LPG 0204	1	Swivel O-Ring	Nbr
LPG 0205	1	Nut	Steel
LPG 0207	1	Lip Gasket	Nbr
LPG 0208	1	Bolt	Steel
LPG 0210	1	Nut	Brass
LPG 0211	1	Screwed Pin	Stee
LPG 0212/B	1	Black Dust Cover	Nbr
LPG 0212/C	1	Blue Dust Cover	Nbr
LPG 0212/G	1	Green Dust Cover	Nbr
LPG 0212/R	1	Red Dust Cover	Nbr
LPG 0212/Y	1	Yellow Dust Cover	Nbr
LPG 0213	1	Bolt	Steel
LPG 0214	1	Gasket Kit Standard	
LPG 0216	1	Lever Screw	Steel
LPG 0217	1	Trigger Pin	Steel

# LPG 800 Series

# HQ

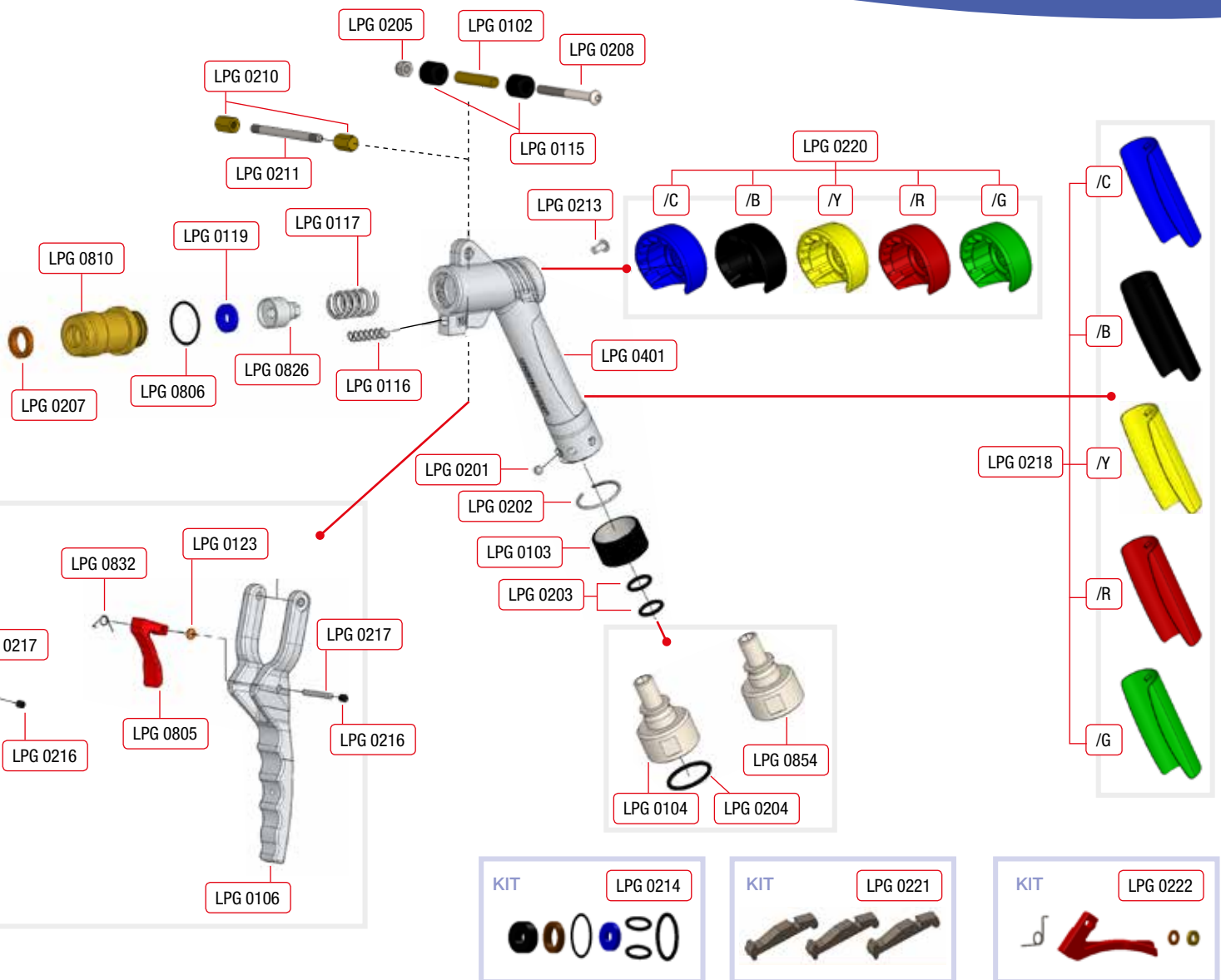

**All of our products are ATEX certified.**

Code	Q.ty	Article	Material
LPG 0218/B	1	Black Body Cover	Abs
LPG 0218/C	1	Blue Body Cover	Abs
LPG 0218/G	1	Green Body Cover	Abs
LPG 0218/R	1	Red Body Cover	Abs
LPG 0218/Y	1	Yellow Body Cover	Abs
LPG 0220/B	1	Black Body Insert	Abs
LPG 0220/C	1	Blue Body Insert	Abs
LPG 0220/G	1	Green Body Insert	Abs
LPG 0220/R	1	Red Body Insert	Abs
LPG 0220/Y	1	Yellow Body Insert	Abs
LPG 0221	1	Standard Hammers Kit	
LPG 0222	1	Trigger Kit	
LPG 0401	1	Series Body HQ	Aluminium
LPG 0805	1	Trigger	Tecnopolim.
LPG 0806	1	Head O-Ring	Nbr

Code	Q.ty	Article	Material
LPG 0810	1	Standard Head	Brass
LPG 0811	1	Standard Piston	Brass
LPG 0813	1	800 Series Aluminium Sleeve	Aluminium
LPG 0820/B	1	Black Lever Cover	Abs
LPG 0820/C	1	Blue Lever Cover	Abs
LPG 0820/G	1	Green Lever Cover	Abs
LPG 0820/R	1	Red Lever Cover	Abs
LPG 0820/Y	1	Yellow Lever Cover	Abs
LPG 0826	1	Valve	Aluminium
LPG 0832	1	Trigger Spring	Steel
LPG 0836	1	800 Series Brass Sleeve	Brass
LPG 0854	1	Swivel NPT 3/4	Steel
LPG 0872	1	White Lever with HS	Aluminium
LPG 0913	1	800 Series Steel Sleeve	Steel



## LPG 800HQ IGSB

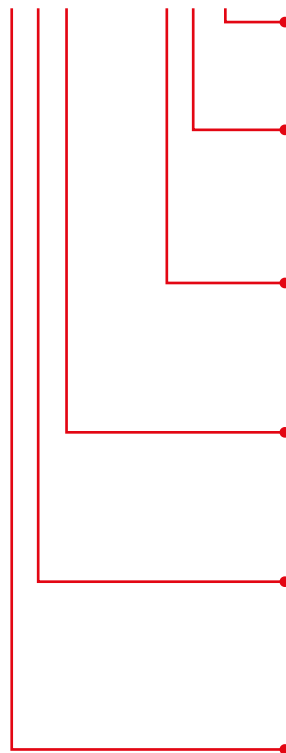

Colour					
Code	C = Blue	B = Black	Y = Yellow	R = Red	G = Green
Screw					
Type	S = Standard		F = France		
Swivel					
Type	G = 1" Gas		N = 3/4" NPT		
Coupling					
Type	I = Italian - DISH				
Lever					
Type	0 = Standard		1 = Standard+HS		
Sleeve material					
Type	0 = Aluminium	2 = Steel	3 = Brass		
Body					
Type	8 = Series HQ				

Maximum operating pressure	25 Bar
Static test	40 Bar
Dynamic test	25 Bar
Maximum Flow Rate	40 l/min @ 8 bar
Release of gas when disconnected	1,3 cm <sup>3</sup>
Operating temperature	-40°C ÷ +85°C

Weight	1,3 Kg. aluminium version
Type of coupling	Italian - DISH
Hooking on car	N°3 Standard hammer
Swivel connection	1" Gas - 3/4 NPT
Sleeve made of anti-spark material	

### INSTRUCTION OF NOZZLE USE

- Align nozzle' sleeve to the vehicle's connector.
- Insert the front part of the sleeve being sure that hammers are inside the connector.
- Pull back on the lever until all the way in order enable the locking. In this position, the valve inside the nozzle is open and the sleeve locked in order prevent the unlocking of the nozzle during the refueling.
- Remove the nozzle from the vehicle connector.
- Place the nozzle on nozzle boot.